

GF30
GG30
GC30

Models

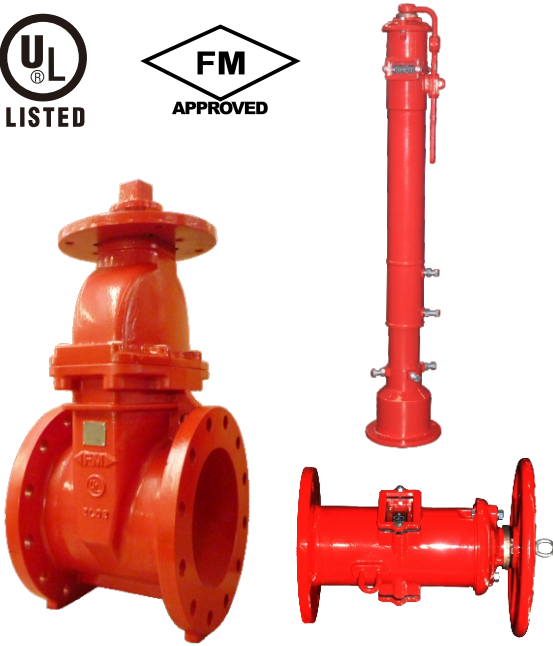

Non-Rising Stem Gate Valve with Vertical or Wall Post Indicator



- U.L. Listed & F.M. Approved
- Resilient wedge design with water tight seating
- Lower torque requirements to operate valve
- Full, unobstructed flow way
- Field Replaceable Parts

Description

The Cla-Val Non-Rising Stem Gate Valves with Vertical or Wall Post Indicator are suitable for use in fire protecting systems. End connection configurations including Flange by Flange, Flange by Groove, and Groove by Groove are available. The waterway is clear and unobstructed. Ductile Iron construction has greater strength, durability and lighter weight than cast iron. Ductile iron wedge fully encapsulated with EPDM rubber ensures zero allowable leakage. All internal parts can be serviced without removing valve out of pipeline.

The valve is constructed with integral lifting device on body which allows the valve to be handled without having to lift the valve by operating nut or handwheel.

All internal and external surfaces have been fusion bonded epoxy coated.

Specification

The gate valve shall be resilient wedge type rated for maximum 300 p.s.i. cold water working pressure. All cast key ferrous components shall be ductile iron, ASTM A536 65-45-12, The wedge shall be single gate construction, ductile iron fully encapsulated with EPDM rubber and seal. The wedge nut shall be independent of the wedge and material shall be corrosion resistant for longer service life.

Gate valve shall be capable of open/shut operation when installed in positions with either flow up or flow down. No wedge in waterway when open to restrict flow or to increase pumping costs.

All materials of construction shall conform to ASTM specifications as follows.

- Body & Bonnet: Ductile Iron A536 65-45-12
- Resilient Wedge: Ductile Iron A536 65-45-12, EPDM encapsulated.
- Stem: Stainless Steel AISI 304
- Stem nut: Bronze ASTM B62



GF30
GG30
GC30

Models



Non-Rising Stem Gate Valve with Vertical or Wall Post Indicator

Non-Rising Stem Gate Valve

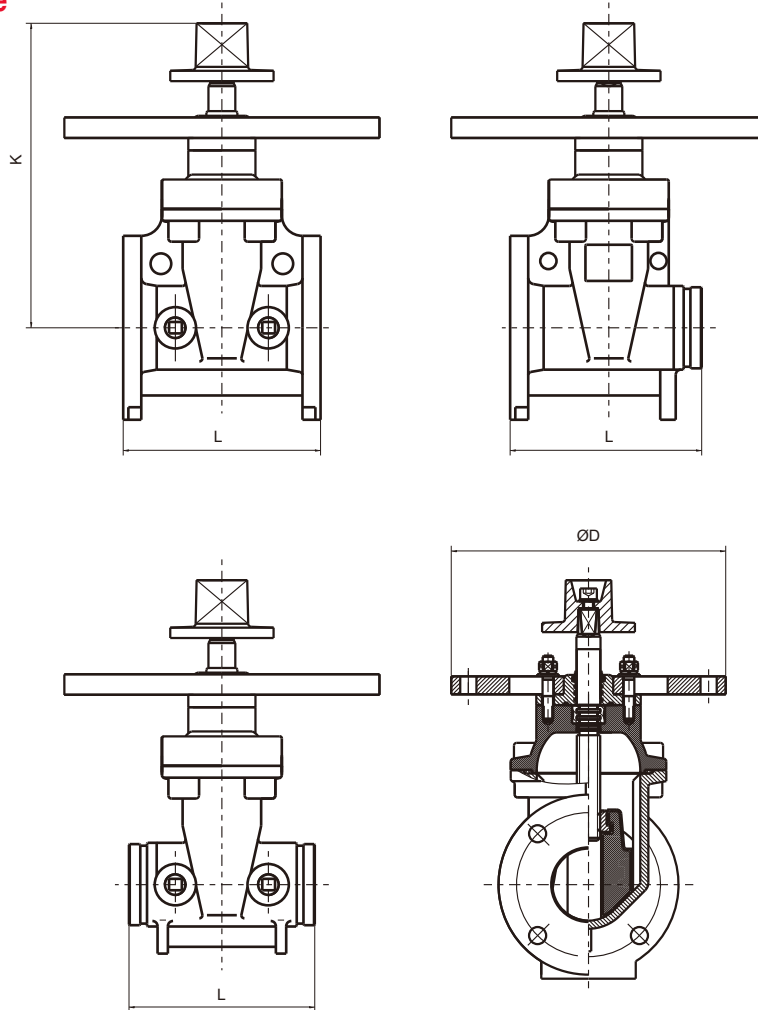

MATERIAL SPECIFICATION

Part Name	Material Description
Body	ASTM A536 65-45-12
Gate	ASTM A536 65-45-12+EPDM
Stem	AISI SS304
Bonnet	ASTM A536 65-45-12
Thrust Collar	ASTM C51100
Gland	ASTM A536 65-45-12
Gate Nut	ASTM A351 CF8
Wrench Nut	ASTM B62
Hex Socket Cap Screw	ASTM SS316
Studs	ASTM SS316

DIMENSIONS

Size	L	K	ØD
DN50	178	295	305
DN65	190	295	305
DN80	203	323	305
DN100	229	342	305
DN125	254	408	305
DN150	267	440	305
DN200	292	537	305
DN250	330	640	305
DN300	356	723	305



GF30
GG30
GC30

Models



Non-Rising Stem Gate Valve with Vertical or Wall Post Indicator

Typical Application

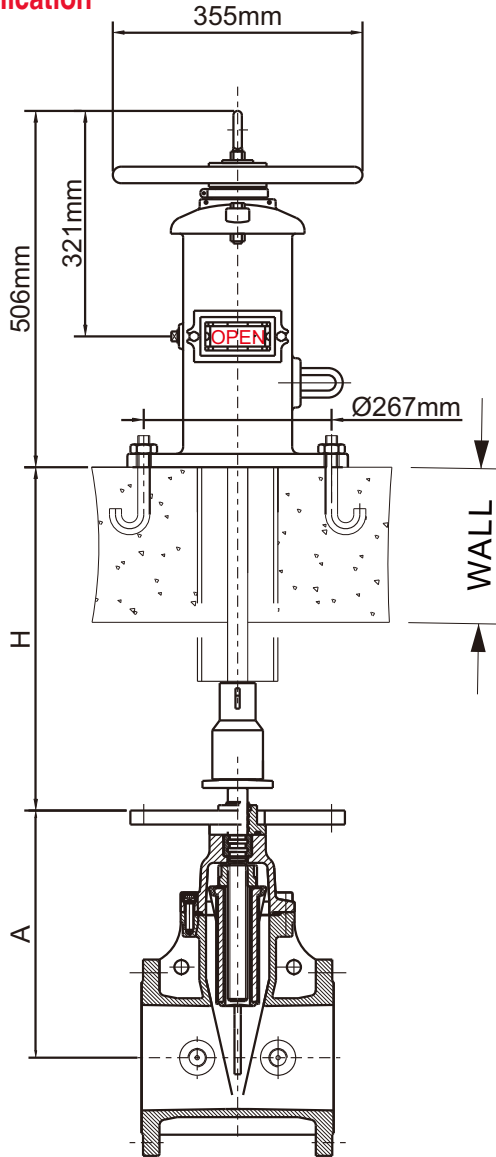

Gate Valve with Wall Post Indicator GF30-W

Valve Size	H(max)	H(min)	A
4"	738	487	251
5"	735	428	320
6"	735	428	352
8"	743	492	435
10"	744	493	535
12"	748	497	616

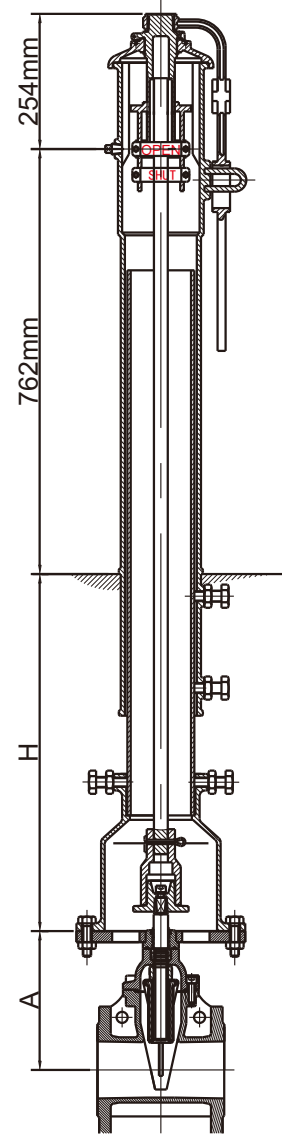

Gate Valve With Vertical Indicator GF30-G

Valve Size	H(max)	H(min)	A
4"	1419	810	251
5"	1419	810	320
6"	1419	810	352
8"	1419	810	435
10"	1419	810	535
12"	1419	810	616

